

NITA-HEMP®

Thermal and acoustic insulation in long fibre mats from the core part of the hemp plant the hemp plant (*cannabis sativa*). It is a natural and renewable material.



MAIN CHARACTERISTICS

- High thermal and acoustic insulation capacity.
- Composition: hemp fibres (>80%) and polyester binder.
- Breathable and hygroscopic.
- Organic, recyclable and from a renewable source.
- Free of toxic and/or allergenic agents.
- Durable and resistant over time.
- Non-abrasive and very easy to install.



DELIVERY FORMAT

Edges of 50mmx 0,6m x 10m in packs of 2 rolls.



RMT INSULATION

ADDRESS: POLÍGONO INDUSTRIAL CAN MAGRE
C/ NARCÍS MONTURIOL 20-22
08187 – SANTA EULALIA DE RONÇANA
BARCELONA (SPAIN)
TELEPHONE: +34 93 844 89 78
E-MAIL: INFO@RMTINSULATION.COM

[CALCULATE
YOUR BUDGET](#)

[VISIT OUR
WEBSITE](#)

TECHNICAL CHARACTERISTICS

Technical characteristics		Thickness (mm)	Format
			Cloaks 30 kg / m ³
Thermal conductivity "λ	W / (m·K)	-	0,041
Thermal resistance	(m ² ·K) / W	50	1,22
		100	2,44
Water vapour diffusion resistance coefficient	μ	-	1
Hygroscopicity	% of its weight	-	12 % ±5%
Fire reaction	UNE-EN-ISO 11925-2	-	F

CONTRAINdicATIONS

- The product cannot be in direct contact with water.
- Any additional treatment on the fiber not included in this information sheet, it may alter its properties and performance and automatically invalidates any warranty on the part of the manufacturer.

PRECAUTIONS FOR USE NITA-HEMP

All elements that emit heat at high temperatures (e.g. chimneys, coils, transformers, motors, luminaires, etc.) must be kept at a distance of 20 cm from the insulation.

Provide perimeter frames on the elements in compliance with the standards in force. These frames can be made of fireproof PYL, with class A fire behaviour, or of insulating bricks 20% higher than the height of the planned insulation.

The hot spots must be protected with specific protection boxes (e.g. cover-lights) and be of sufficient height and diameter to ensure good protection.

In all scenarios, it is imperative to respect NF DTU 24-1 for the treatment of flues. And DTU 70-1 and 70-2 for the treatment of electronic elements.

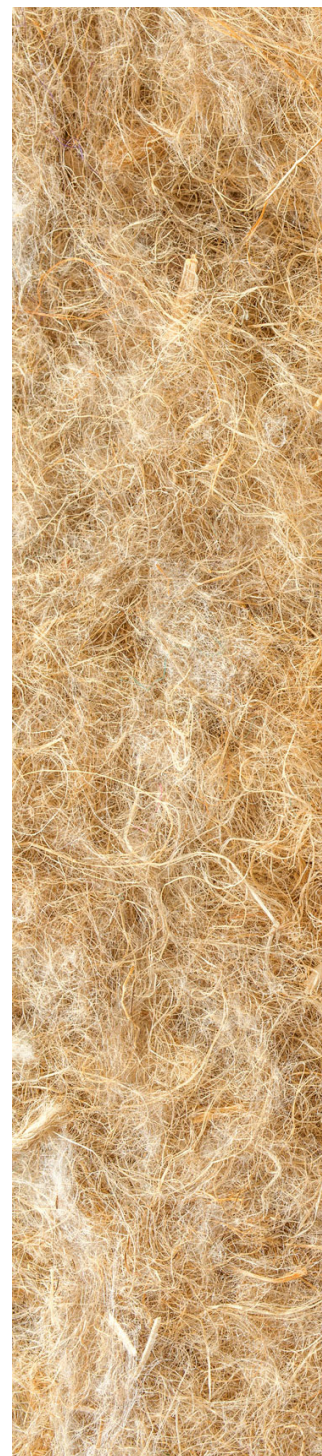
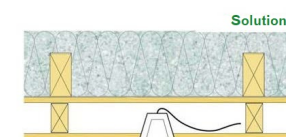
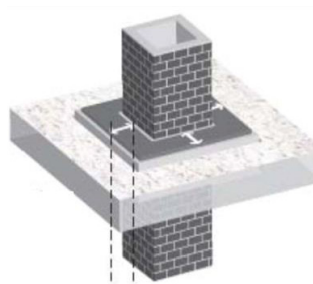

RMT INSULATION

ADDRESS: POLÍGONO INDUSTRIAL CAN MAGRE
 C/ NARCÍS MONTURIOL 20-22
 08187 – SANTA EULALIA DE RONÇANA
 BARCELONA (SPAIN)
 TELEPHONE: +34 93 844 89 78
 E-MAIL: INFO@RMTINSULATION.COM

[CALCULATE YOUR BUDGET](#)

[VISIT OUR WEBSITE](#)